

ATTENTION!!! IMPORTANT PRINTING INSTRUCTIONS...

This file is intended to be printed to scale. To insure that your print is to scale, make sure "Fit to page" is *unchecked* when printing. After printing this document, accuracy can be checked by measuring the overall length and width of the template and cross-referencing these dimensions with those listed with the part.

This recoil pad is designed to fit the specific synthetic stock(s) listed below. To convert this pad to fit a flat butt wood stock, or a synthetic stock not listed, you may have to remove the hatched areas shown. 

Sims Vibration Laboratory
301 W. Business Park Loop
Shelton, WA 98584
Toll Free: 877.257.2761
Fax: 360.427.4025sales@limbsaver.com
www.limbsaver.com

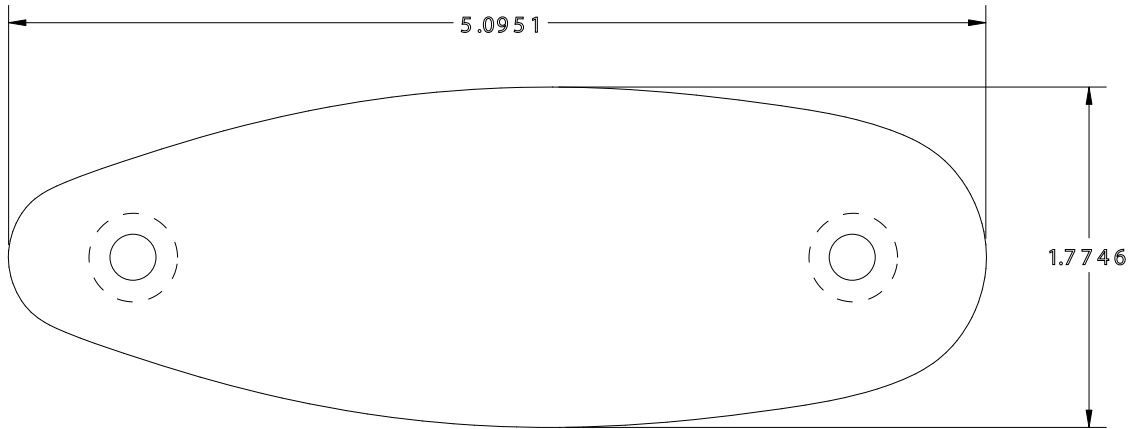

Item# 10401

